

Safety

- Do not cover the ground contact.
- Do not cover the luminaire, hang or fasten anything from it.
- Do not operate if any visible damage can be seen to the product.
- Do not operate if any water ingress has occurred.
- Do not operate if any smoke, steam or crackling noises can be heard from the luminaire.
- Do not operate if any signs of overheating are recognised.
- Avoid installation in any areas where there is a risk of strong mechanical loads.
- Do not place any material over the lens or LED diode/chip.
- Do not insert objects into the luminaire.
- Do not clean using any solvent based abrasive or aggressive product.
- Do not pull any cables connected to the product.
- Do not direct the luminaire into a persons eyes, as this unit may have an intense light output, which if incorrectly used may cause eye damage.
- Light engines/LED'S and other light sources may heat up, please take care when handling the products.
- The manufacturer will not be deemed liable or held responsible for any damages caused by faults or manufacturing defects that may be present in any of its products or the misuse or incorrect installation of this device. Please refer to our trouble shooting guide for further information.
- The manufacturer will not be held liable for any death(s) or injuries caused by misuse or poor installation or any unreported faults of this product version or versions thereof.
- LED's are sensitive to electrostatic discharge. Do not touch the surface of the LED module.
- Do not connect to a temporary electricity supply, this may damage the electronics.
- Light fittings with an integrated emergency option are with a separate installation and wiring leaflet. Please refer to this manual for further details. If the manual is unavailable please contact an ALL LED representative for assistance.
- REPLACE DAMAGED PRODUCT IMMEDIATELY.
- Keep away from children.

Returns & Faulty Items

- If any problem is encountered during or after installation, please call ALL LED technical department to get the problem resolved ASAP.
- Please do not just return the item to the outlet you purchased it from, as you are only entitled to a replacement or refund after the unit has undergone testing and the unit has been confirmed as having a manufacturing defect/fault. Your statutory rights are not affected.
- The manufacturer will not be deemed liable or held responsible for any damages caused by faults or manufacturing defects that may be present in any of its products or the misuse or incorrect installation of this device.
- All installations must be carried out in accordance with this installation guide and user manual.
- All goods are supplied under the terms and conditions of ALL LED LTD, a copy of which may be obtained upon written request.

Environmental Protection
Waste electrical products should not be disposed of with household waste. Please recycle where facilities exist. Check with your Local Authority or retailer for recycling advice



This product supplied with a limited 5 year guarantee, subject to terms and conditions. The manufacturer will not be deemed liable or held responsible for any damages caused by faults or manufacturing defects that may be present in any of its products or the misuse or incorrect installation of this device. Your statutory rights are not affected.

ALL-LED USA LLC
12035 34th St N, Suite 2
St Petersburg
FL 33716 USA

Website: www.all-ledusa.com
Email: sales@all-ledusa.com



INSTALLATION GUIDE AL-LPUD40 Range



ENSURE POWER SUPPLY IS OFF WHEN HANDLING ANY ELECTRICAL EQUIPMENT.

- This product must be installed by a qualified electrical installer.
- Please read this guide in its entirety to fully understand the products before attempting any install.
- All electrical work should be completed in accordance with the latest IET regulations, and/or any other relevant rules, regulations or laws of the country in which it is being installed.
- The item must be installed in isolation from any insulating material and is adequately ventilated to prevent premature failure.
- Ensure power is isolated prior to installation, maintenance or performing any other form of electrical work.
- In the event of incorrect or improper function with specific regard to any of ALL LED's products and contact ALL LED for further advice.

SAFETY WARNING

- ENSURE THE PLASTIC LOCATED ON TOP OF THE LED'S IS NEVER REMOVED OR TAMPERED WITH.
- IF THERE IS ANY VISIBLE DAMAGE TO THIS ITEM, PLEASE ENSURE THAT THE POWER IS SWITCHED OFF AND REMAINS OFF. IMMEDIATELY REPLACE THE UNIT.
- DO NOT TOUCH THE LED CHIPS AT ANY POINT DURING, OR AFTER INSTALLATION OF THE LUMINAIRE AS THERE IS RISK OF ELECTRICAL SHOCK.

SAVE THESE INSTRUCTIONS

- Use only in the manner intended by the manufacturer. If you have any questions, contact .
- Each luminaire is to be used with Internal driver.
- Wiring to be performed by qualified electrician only.
- Wiping on the light emitting plate(LGP) is not allowed, which will cause damage.
- There are spare screws in the accessory KIT.
- 4FTX8 Inch: Luminaire - Only connect a maximum of 9pcs lights together in 120V AC and up to 20 units running 277V AC.

RISK OF ELECTRIC SHOCK

- Turn power off before inspection, installation or removal.
- Properly ground electrical enclosure.

RISK OF FIRE

- Follow all NEC and local codes.
- Use only UL or IEC approved wire for input/output connections. Minimum size 18 AWG (0.82mm2).

RISQUES DE DÉCHARGES ÉLECTRIQUES

- Coupez l'alimentation avant d'inspecter, installer ou déplacer le luminaire.
- Assurez-vous de correctement mettre à la terre le boîtier d'alimentation électrique.

RISQUES D'INCENDIE

- Respectez tous les codes NEC et codes locaux.
- N'utilisez que des fils approuvés par UL ou IEC pour les entrées/sorties de connexion.
Taille minimum size 18 AWG (0.82mm2).



ISOLATE MAINS SUPPLY
BEFORE HANDLING ANY
ELECTRICAL PRODUCTS

4FTX8 Inch Luminaire

(Input:100-277V/AC, Power: 40W, PF>0.9, 50/60Hz)



Define Distance Between Canopy Sets

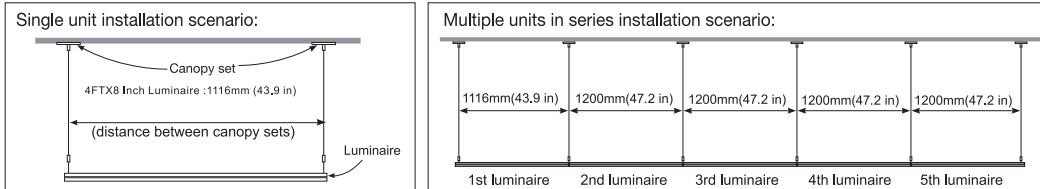

Example: To install five units in series, the distance between canopy sets for the 1st (left) and 5th (right) luminaire is 1116mm (43.9in), and the distance between canopy sets for the 2nd, 3rd and 4th (middle) luminaires is 1200mm (47.2 in).

Optional Mounting Method - Installation for Continuous Runs

For multiple units linked, Only the first canopy set will require an AC Input cable. Please contact the technical department should you be linking over 6 units.

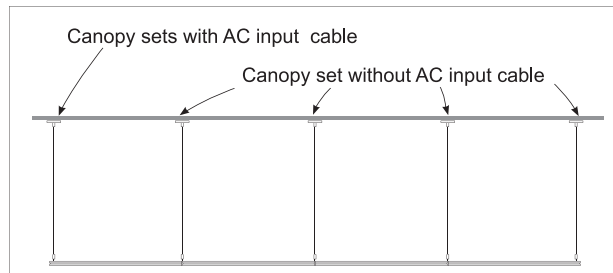

For 0-10V Dimming

For 0-10V Dimming Compatible with 0-10V dimmer The driver PUR (D+) to the dimmer-(PUR),and the driver GRY (D-) to the dimmer-(GRY) Connect the wires with terminal cap as shown in wiring diagram (Figure 6).Incoming insulated dimming conductors shall have voltage rated at least equal to the branch voltage.

For non-dimming

Connect the driver PUR(D+) to the driver GRY(D-)

WIRING DIAGRAM

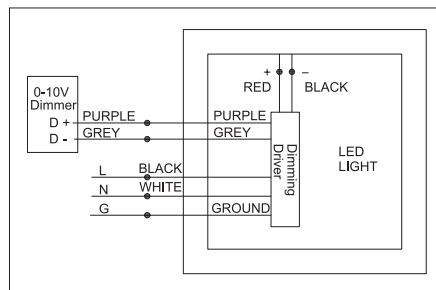

Installation for Independent Unit

Connect AC input cable Blackwire with L, white wire with N, Green wire with Ground, Purple wire with dimmer + ,Gray wire with dimmer - .

Install the base onto the ceiling using an appropriate fixing relative to the ceiling substrate. Pass the grommet over the cable and through the small knockout to allow the cable to move through the hole without the risk of fraying or cutting.

Secure all male sides of the suspension points on to the ceiling using an appropriate method.

Connect all the female ends of the suspension kits on the product and twist onto male bases secured on the ceiling. Amend the height using the suspension points, avoid cutting suspension wire as it may fray.

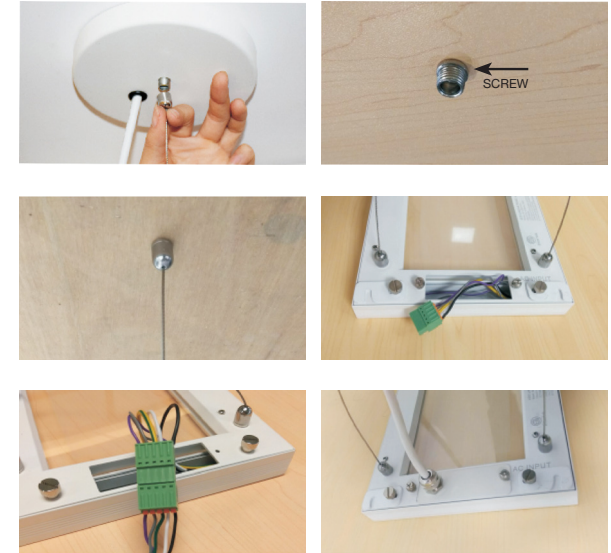

Installation for Interlinking

To link fixtures, POWER OFF

Open the wire covers on the opposite side of the fixture to the power source.

Connect the joining sheet metal components and tighten the screws to secure the two panels together.

Connect the green male and female connectors and tuck away.

Use the cover provided with a 'bump' to accommodate the internal wires. Carefully place the cover over the connection and tighten the screws.

